

Verrier Road Bristol BS5 9LH • £250,000



3 BEDROOMS • 1 BATHROOMS • 1 RECEPTIONS • TENURE: Freehold

THREE BEDROOMS
DOUBLE BAY
OPEN PLAN LIVING
GALLEY STYLE KITCHEN AREA
PERIOD FEATURES
NO CHAIN
FULL WIDTH MASTER BEDROOM

Set in the heart of popular Redfield within a stone's throw of Church Road; one of Bristol's most vibrant, creative and colourful streets and walking distance of St George's Park, Train Stations and the City Centre sits this well presented and extended three bedroom period home! The property comprises of an entrance hallway leading to an open plan living consisting of a bay lounge, full-width dining area, galley style kitchen and family bathroom to the ground floor along with three bedrooms [two doubles, full-width master bedroom] to the first floor. Further benefits include; gas central heating, double glazing, period features, an enclosed & low maintenance rear garden and NO CHAIN!



GROUND FLOOR

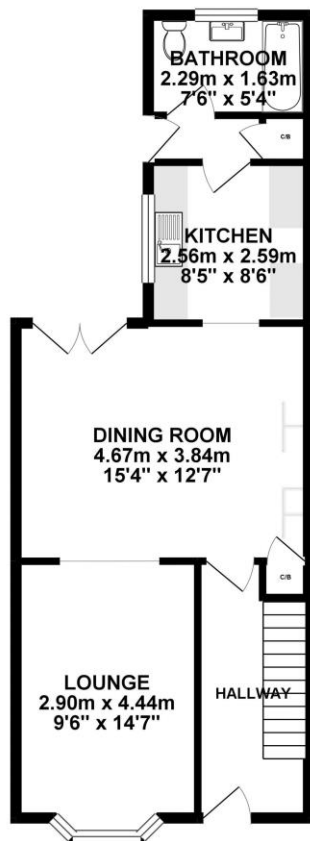

1ST FLOOR

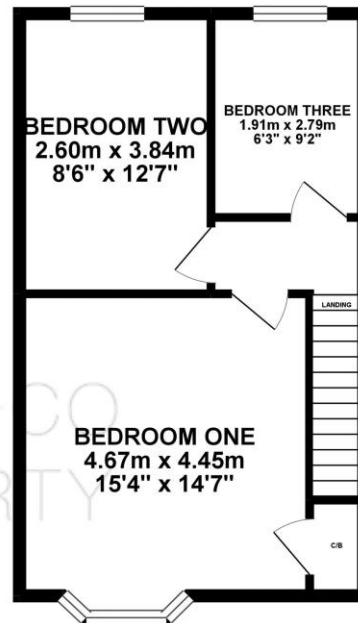

Whilst every attempt has been made to ensure the accuracy of the floorplan contained here, measurements of doors, windows, rooms and any other items are approximate and no responsibility is taken for any error, omission or mis-statement. This plan is for illustrative purposes only and should be used as such by any prospective purchaser. The services, systems and appliances shown have not been tested and no guarantee as to their operability or efficiency can be given.
Made with Mapbox ©2019



Room sizes

GROUND FLOOR

Hallway

Lounge

14' 7" x 9' 6" (4.44m x 2.89m)

Dining Room

15' 4" x 12' 7" (4.67m x 3.83m)

Kitchen

8' 6" x 8' 5" (2.59m x 2.56m)

Bathroom

5' 4" x 7' 6" (1.62m x 2.28m)

FIRST FLOOR

Landing

Bedroom One

15' 4" x 14' 7" (4.67m x 4.44m)

Bedroom Two

8' 6" x 12' 7" (2.59m x 3.83m)

Bedroom Three

9' 2" x 6' 3" (2.79m x 1.90m)



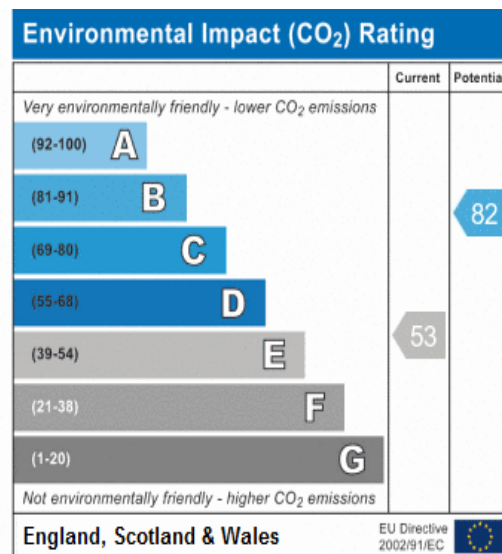
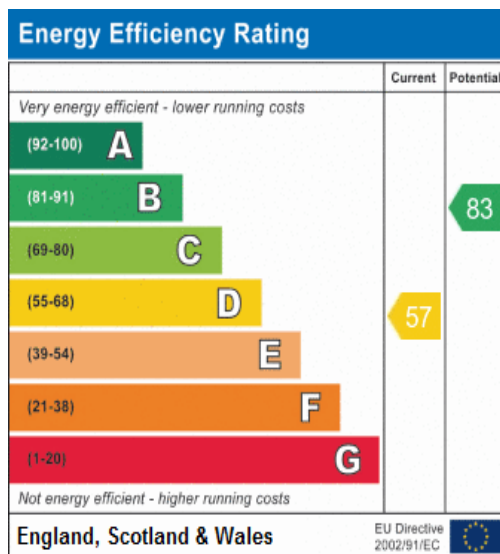

General information

Money Laundering Regulations 2003 – Intending purchasers will be asked to produce identification documents prior to the agreement of a sale. You will be informed of acceptable documentation upon making an offer to this office.

These particulars do not constitute part or all of an offer of contract.

The measurements indicated are supplied for guidance only and as such must be considered approximate.

Potential buyers are advised to recheck the measurements before committing to any expense.

House + Co Property have not tested any equipment, fixture, fitting, apparatus or services and cannot guarantee that they are in working order.

House + Co Property have not sought to verify the legal title of the property and the buyers must obtain verification from their legal representative.

House + Co Property prepared these details for themselves in good faith and whilst believed to be correct, we give notice that none of the statements contained in these particulars for this property are to be relied upon as statements or representation of fact. Some statements are inevitably subjective, and are therefore the view of the author at the time the information was prepared. If any items are important to you, then please check with the office first, especially if you are travelling some distance to view.

Note regarding floorplan

The computer-generated floor plan is intended as a general guide to the layout and design of the property. It is not to scale and should not be relied upon for accuracy. Purchasers should satisfy themselves as to the layout of the property prior to making any decision to buy.