

Greenbank View Bristol BS5 6LG • £995pcm



2 BEDROOMS • 1 BATHROOMS • 1 RECEPTIONS

**Professionally Managed By House + Co
Property**
Unfurnished with Cooker and Fridge
Freezer Included
Views Across Greenbank Cemetary
Two Bedrooms

Set with reaching views across Greenback Cemetery and with convenient access to the Bristol to Bath Cycle Track, commuting routes and local amenities is this two bedroom home. The accommodation comprises of entrance hallway leading to a full-width lounge and Kitchen to the ground floor along with two bedrooms and shower room to the first floor. Further benefits includes gas central heating and an enclosed private rear garden with a raised patio area. Offered unfurnished and available to occupy from 23rd November 2020.



GROUND FLOOR

1ST FLOOR

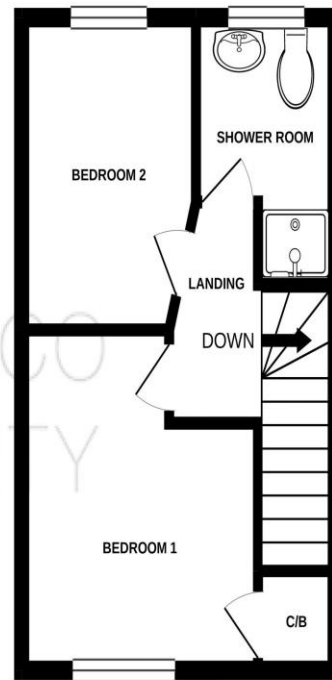
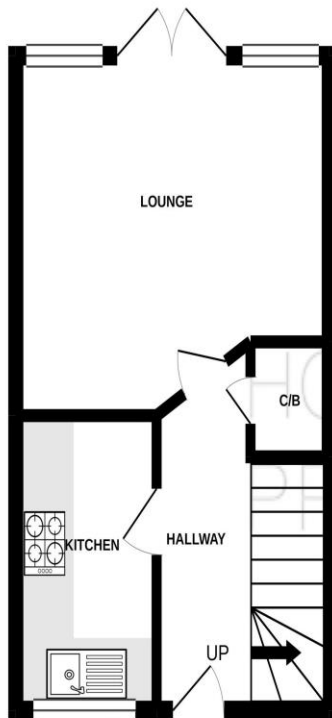

Whilst every attempt has been made to ensure the accuracy of the floorplan contained here, measurements of doors, windows, rooms and any other items are approximate and no responsibility is taken for any error, omission or mis-statement. This plan is for illustrative purposes only and should be used as such by any prospective purchaser. The services, systems and appliances shown have not been tested and no guarantee as to their operability or efficiency can be given.
Made with Metropix ©2020

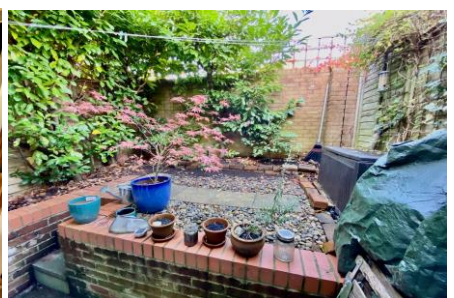

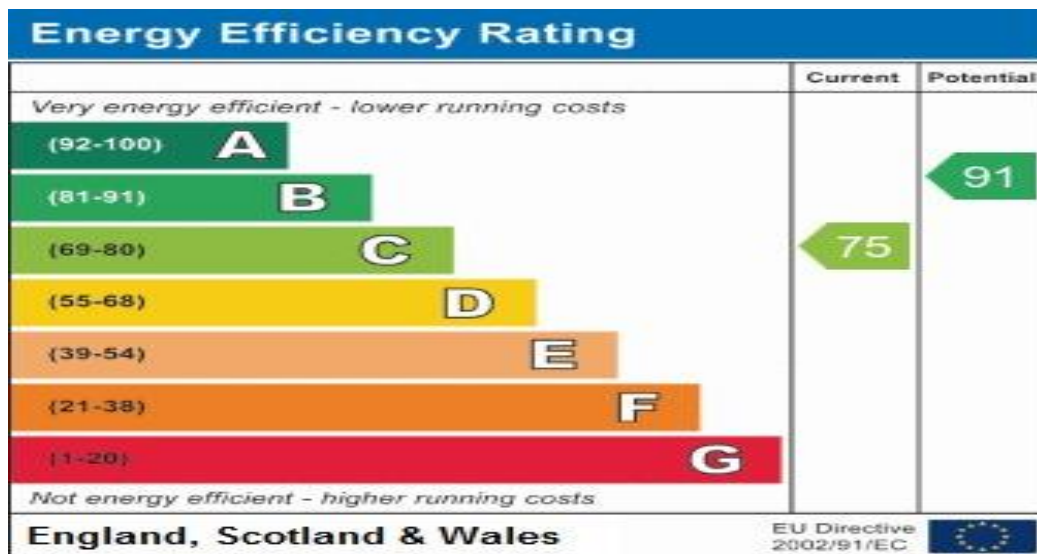

General information

Money Laundering Regulations 2003 – Intending tenants will be asked to produce identification documents prior to the agreement of a letting. You will be informed of acceptable documentation upon making an offer to this office.

These particulars do not constitute part or all of an offer of contract.

House + Co Property have not tested any equipment, fixture, fitting, apparatus or services and cannot guarantee that they are in working order.

House + Co Property have not sought to verify the legal title of the property and the tenants must obtain verification from their legal representative.

House + Co Property prepared these details for themselves in good faith and whilst believed to be correct, we give notice that none of the statements contained in these particulars for this property are to be relied upon as statements or representation of fact. Some statements are inevitably subjective, and are therefore the view of the author at the time the information was prepared. If any items are important to you, then please check with the office first, especially if you are travelling some distance to view.

Note regarding floorplan

The computer-generated floor plan is intended as a general guide to the layout and design of the property. It is not to scale and should not be relied upon for accuracy. Tenants should satisfy themselves as to the layout of the property prior to making any decision to rent.